

ORIGINAL

ORDINANCE NO. 922

AN ORDINANCE FOR THE CITY OF REDMOND, WASHINGTON, AMENDING THE OFFICIAL ZONING MAP OF THE CITY OF REDMOND AS ADOPTED BY SECTION 20C.10.030 OF THE REDMOND MUNICIPAL CODE AND COMMUNITY DEVELOPMENT GUIDE; AND THE LAND USE PLAN MAP ADOPTED BY SECTION 20B.90.040 OF THE REDMOND MUNICIPAL CODE AND COMMUNITY DEVELOPMENT GUIDE BY CHANGING THE LAND USE PLAN DESIGNATION AND ZONING CLASSIFICATION OF CERTAIN PROPERTY WITHIN THE CITY FROM AN EXISTING LAND USE PLAN DESIGNATION OF BUSINESS TO A NEW LAND USE PLAN DESIGNATION OF BUSINESS PARK AND FROM AN EXISTING ZONING CLASSIFICATION OF GENERAL (G) TO A NEW ZONING CLASSIFICATION OF BUSINESS PARK DISTRICT (BP) AND ESTABLISHING AN EFFECTIVE DATE.

---

WHEREAS, the Redmond Policy Advisory Commission held a public hearing on April 23, 1980, and following said public hearing forwarded its recommendations that certain changes be made to the Land Use Plan and the Official Zoning Map, and

WHEREAS, the City Council of the City of Redmond, following receipt of said recommendation called a public meeting and during said meeting having determined as follows:

1. That the proposed amendments are consistent with the City's goals, policies, plans and programs;
2. That the proposed Business Park Land Use Plan designation and Business Park zoning are consistent with adjoining land uses;
3. That the proposed changes will be in the interest of the public, will not be materially detrimental to surrounding properties or uses, and provide the owners of said properties with economically viable uses of the property, now, therefore,

THE CITY COUNCIL OF THE CITY OF REDMOND, WASHINGTON,  
DO ORDAIN AS FOLLOWS:

Section 1. The Land Use Plan and Land Use Plan Map adopted by Section 20B.90.040 of the Redmond Municipal Code and Community Development Guide are hereby amended to

change the designation on that certain property depicted in Exhibit "A", attached hereto and hereby incorporated in full by this reference, from Land Use Plan designation Business to Land Use Plan designation Business Park.

Section 2. The Official Zoning Map adopted by Section 20C.10.030 of the Redmond Municipal Code and Community Development Guide is hereby amended to change the zoning classification on the real property depicted in Exhibit "A" from General (G) to Business Park District (BP).

Section 3. The Director of Planning and Community Development is hereby instructed to effectuate the changes to the Land Use Plan and Zoning Map in accordance with Section 1 and Section 2 of this ordinance.

Section 4. This ordinance shall be in full force and effect five (5) days after its passage and publication as provided by law.

CITY OF REDMOND

  
MAYOR, CHRISTINE T. HIMES

ATTEST/AUTHENTICATED:

  
CITY CLERK, PAUL F. KUSAKABE

APPROVED AS TO FORM:  
OFFICE OF THE CITY ATTORNEY:

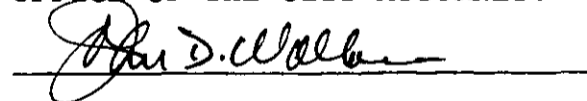

FILED WITH THE CITY CLERK: May 13, 1980  
PASSED BY THE CITY COUNCIL: May 20, 1980  
SIGNED BY THE MAYOR: May 20, 1980  
PUBLISHED: May 28, 1980  
EFFECTIVE DATE: June 02, 1980

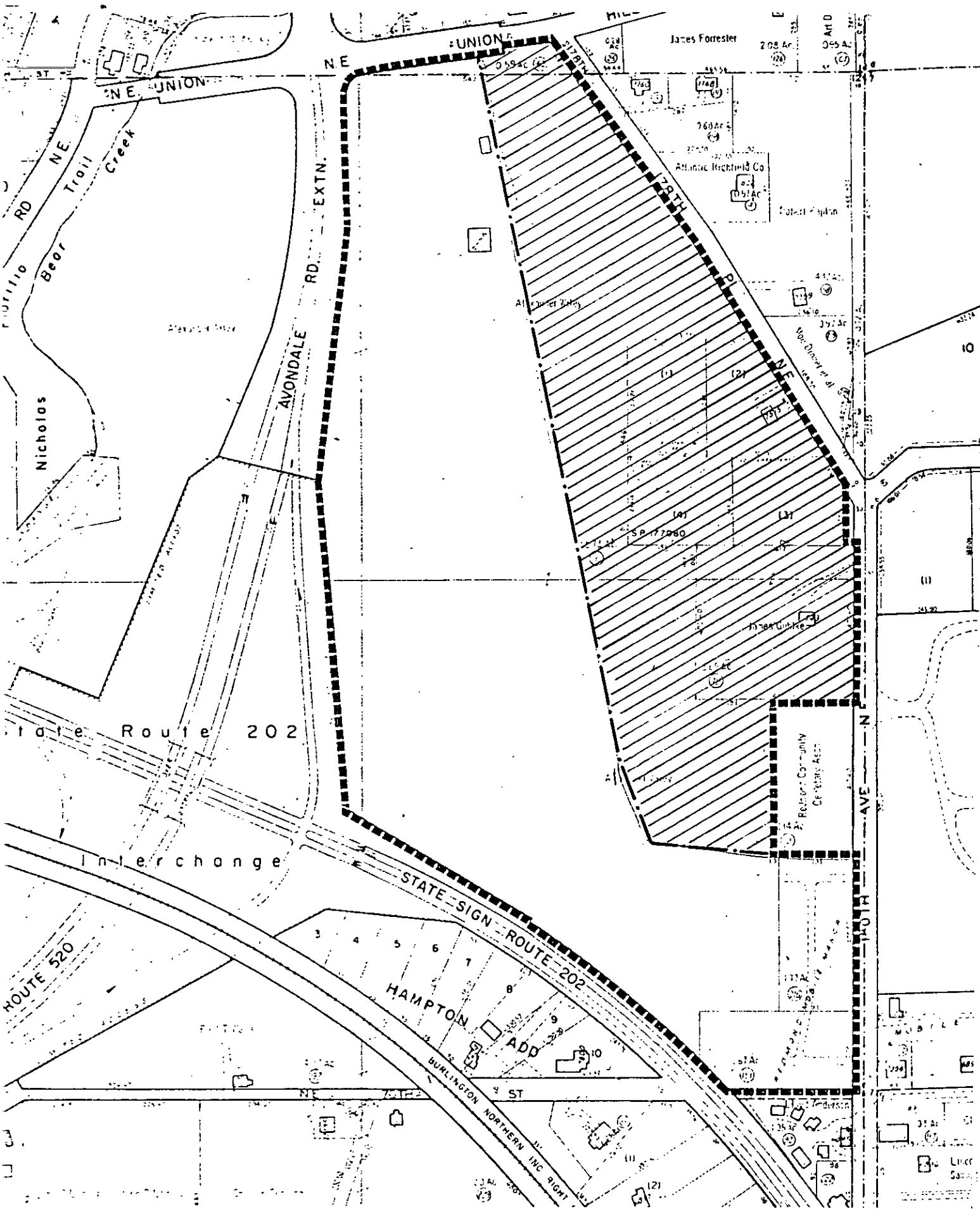

Exhibit "A" (DGA-80-3)

Ordinance No. 922